

AUSTAL PATROL 40



PRINCIPAL DIMENSIONS

Length overall	39.5 metres
Beam (moulded)	8.1 metres
Draft, Loaded (approx.)	2.5 metres

COMMUNICATION & SENSORS

Communication	VHF/DSC Radios, MF/HF DSC Radios, VHF Aeroband Radio, UHF Military Radio, Inmarsat C, SatCom, HF and VHF Radio Direction Finder
Navigation	X-Band Radar, Electronic Chart System, DGPS, Gyrocompass, Autopilot, Depth Sounder

ACCOMMODATION

Berths	23
--------	----

ARMAMENT

Space and weight reservation for a single foredeck mounted naval gun, port and starboard midship machine guns

ADDITIONAL FEATURES

Ship's Boat	1 x Work Ribs (WRH635FRB) SOLAS approved Fast rescue boat for 15 persons @ 100kg Powered by 2x90hp outboard motors
Cargo Deck	16m² with lashing grid serviced by crane

PROPULSION

Main engines	2 x Caterpillar 3516C 2 x 2000 bkW @ 1600 rpm
Gearboxes	2 x ZF 7650A (with trolling valves)
Propellers	2 x fixed pitch

PERFORMANCE

Speed (SS4)	20 knots at 100% MCR
Range at 12 knots (SS4)	3,000 nm

CLASSIFICATION

Lloyd's Register
✶ 100A1 SSC Patrol Mono HSC G6 MCH



YARD NO: 521 - 542

DESTINATION: PACIFIC ISLAND NATIONS*

DELIVERY: 2018 - 2024

CLIENT: COMMONWEALTH OF AUSTRALIA

AUSTAL PATROL 40

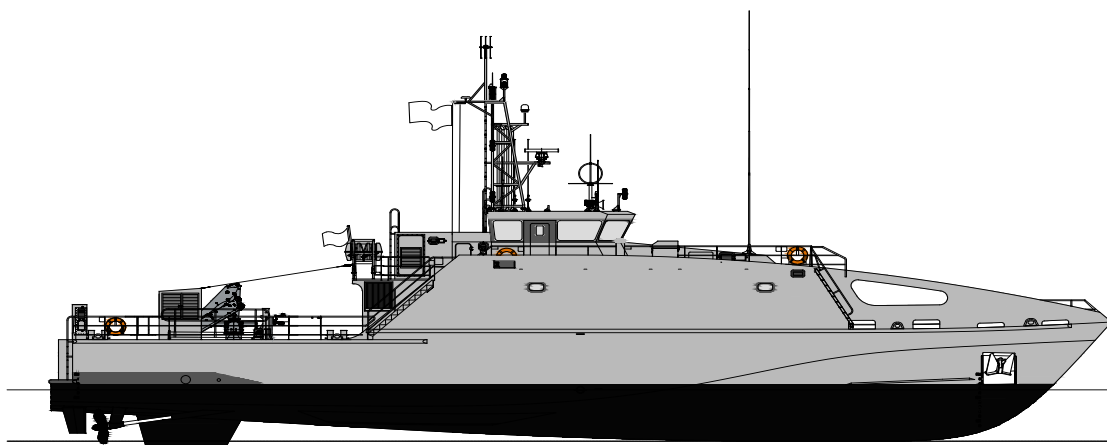

PROFILE

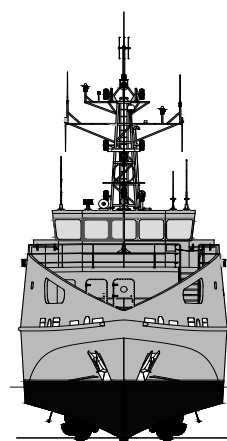

FWD ELEVATION

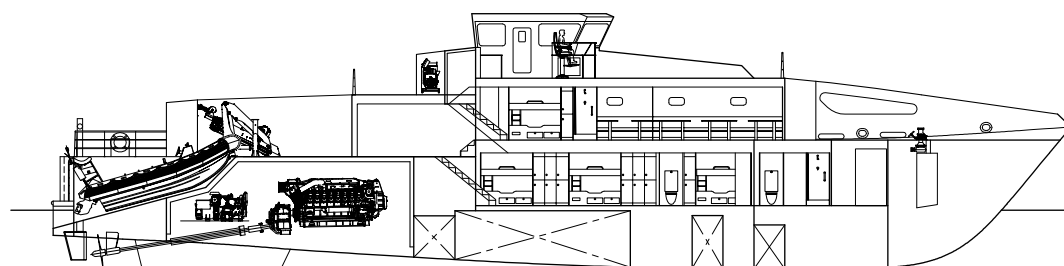

PROFILE @ CENTRELINE

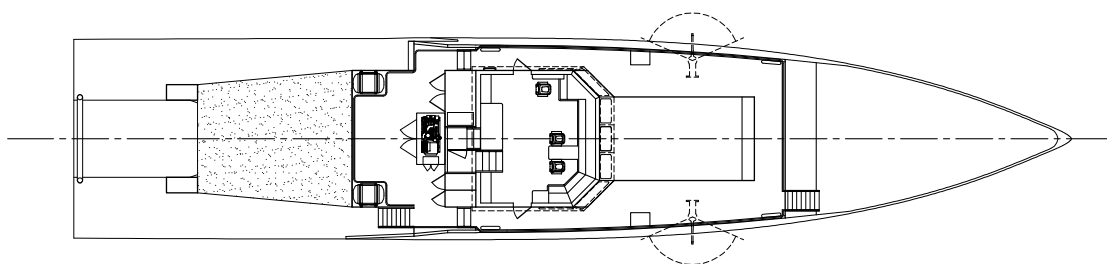

BRIDGE

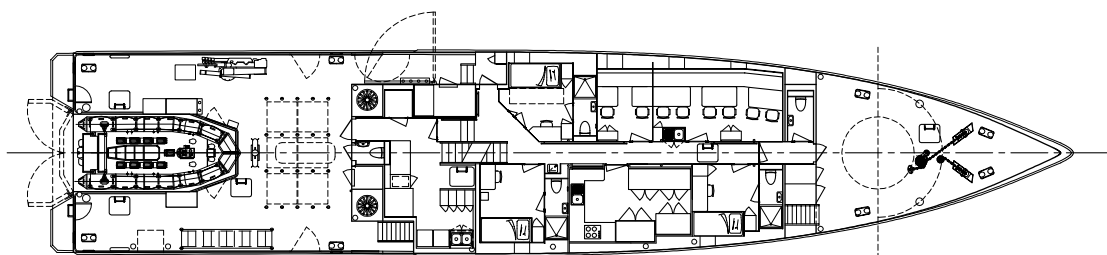

MAIN DECK

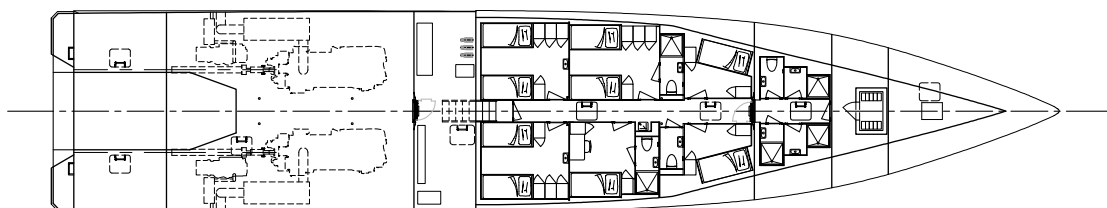

LOWER DECK

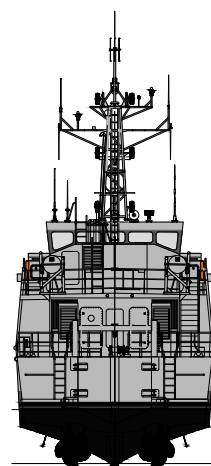

AFT ELEVATION

GUARDIAN CLASS PATROL BOAT

YARD NO: 521 - 542

DESTINATION: PACIFIC ISLAND NATIONS*

DELIVERY: 2018 - 2024

CLIENT: COMMONWEALTH OF AUSTRALIA

* GCPBs to be delivered to 12 Pacific Island nations and Timor-Leste. Pacific Island nations include Papua New Guinea, Fiji, Tonga, Kiribati, Cook Islands, Solomon Islands, Federated States of Micronesia, Marshall Islands, Palau, Samoa, Tuvalu and Vanuatu.

100 Clarence Beach Road
Henderson | Tel +61 8 9410 1111
sales@austal.com
www.austal.com

